

DATED

1st June

1998

MONMOUTHSHIRE COUNTY COUNCIL (FOULING OF LAND BY DOGS)
(MONMOUTHSHIRE) DESIGNATION ORDER (NO.1) 1998

S.M.W.Andrews
Deputy Chief Executive and Solicitor
Monmouthshire County Council
County Hall
Cwmbran
NP44 2XH

NW/A10.0006

THE DOGS (FOULING OF LAND) ACT 1996

MONMOUTHSHIRE COUNTY COUNCIL (FOULING OF LAND BY DOGS) (MONMOUTHSHIRE) DESIGNATION ORDER (NO.1) 1998

Monmouthshire County Council (in this Order called "the Council") hereby make the following Order:

1. The land described in Part I and II of the Schedule below and in respect of the land described in Part II of the Schedule also shown coloured red on the maps attached to this Order being land in the area of the Council which is land to which the Dogs (Fouling of Land) Act 1996 applies, is hereby designated for the purposes of that Act.
2. The Order may be cited as the Monmouthshire County Council (Fouling of Land by Dogs)(Monmouthshire) Designation Order (No.1) 1998 and shall come into force on 29th June 1998

SCHEDULE

Part I

Land designated by description

1. Carriageways with a speed limit of 40 m.p.h. or less and adjoining footpaths, verges and embankments.
2. Parks, recreation grounds, public walks, pleasure grounds, playing fields and playgrounds maintained by the Council.
3. All cemeteries within the County.
4. Cycle tracks maintained by the Council.
5. Car parks maintained by the Council.
6. Grounds surrounding village halls.
7. Registered village greens but excluding the dog exercise area which forms part of Chippenham Mead Village Green at Monmouth.
8. Housing amenity areas being parcels of land held by the Council by virtue of section 12 of the Housing Act 1985 which are not covered by buildings or included in the curtilage of a building or forming part of a highway.
9. Land laid or sown with grass or planted with trees, shrubs or plants and mown or otherwise maintained in an ornamental condition by the Council.
10. Land which is used as an amenity area or for the purpose of public open space, recreation or lies waste or unoccupied and not being land falling within the description contained in section 1(3) of the Dogs (Fouling of Land) Act 1996

11. Paved areas, steps and subways, shopping precincts and arcades, pedestrian areas and bridges not comprised in or running alongside a highway
12. Lanes, courts, alleys, squares, footways, passages, walkway and all public rights of way, whether a throughfare or not

Part II

Land designated specifically

1. Llanbadoc Island
2. The Island, Usk
3. Caldicot Castle County Park
4. The Old Station, Tintern
5. Angidy Ironworks, Tintern
6. Black Rock Picnic Site, Portskewett
7. Bluebell Green Picnic Site, Wentwood
8. Clydach Picnic Site, Caravan Site and Ironworks
9. Goytre Wood
10. Vauxhall Fields
11. Gilwern Picnic Site
12. Bailey Park, Abergavenny
13. Belgrave Park, Abergavenny
14. Linda Vista Gardens, Abergavenny
15. Rogiet Playing Fields
16. St Mary Place Playing Field, Caldicot
17. Hardwick Avenue Playing Field, Chepstow
18. The Warren, off Alpha Road, Chepstow
19. Western Avenue Playing Field, Chepstow
20. Thornwell Playing Fields, Chepstow
21. Castle Dell, Chepstow

22. Chepstow River Bank
23. Playing Fields to the rear of Magor School
24. Undy Playing Fields
25. Llandewi Rhydderch Play Area
26. Llanvapley Cricket and Play Area
27. Llanvair Kilgeddin Play Area
28. Monmouth School Playing Fields
29. Usk Cricket Ground
30. Abergavenny Cricket Ground

Dated this *first* day of *June*
ninety eight

one thousand nine hundred and

GIVEN under the **COMMON SEAL** of)
MONMOUTHSHIRE COUNTY COUNCIL)

G. Powell
Member of the Council
[Signature]
Deputy Chief Executive and Solicitor

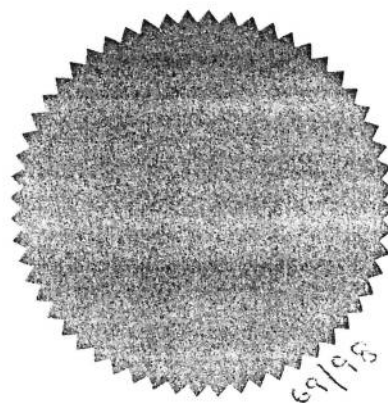

The material in this plot has been reproduced from an Ordnance Survey map with permission of The Controller of Her Majesty's Stationery Office, © Crown copyright. LICENCE NO. LA 09012L

Lanbadoc Island.

Drawn	repro	25/09/97
Traced		
Checked		
Print		
Centred on : 337853 199887		
Scale 1: 3500		
DRG. No.		

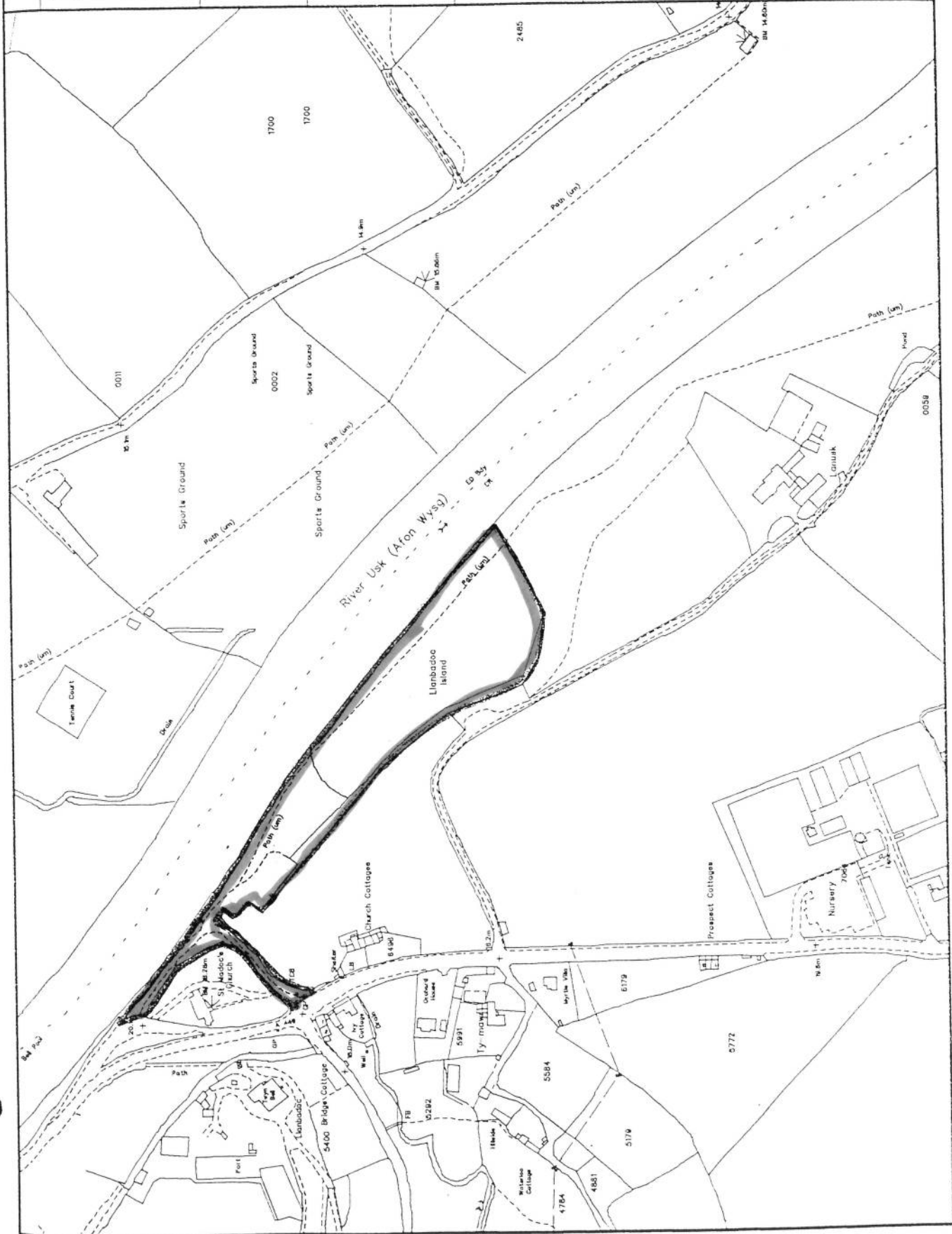

The material in this plot has been reproduced from an Ordnance Survey map with permission of The Controller of Her Majesty's Stationery Office, © Crown copyright. LICENCE NO. LA 09012L

Caldicot Castle Country Park.

Drawn	repro	24/09/97
Traced		
Checked		
Print		
Centred on :		348730 188466
Scale	1:	4000
DRG. No.		

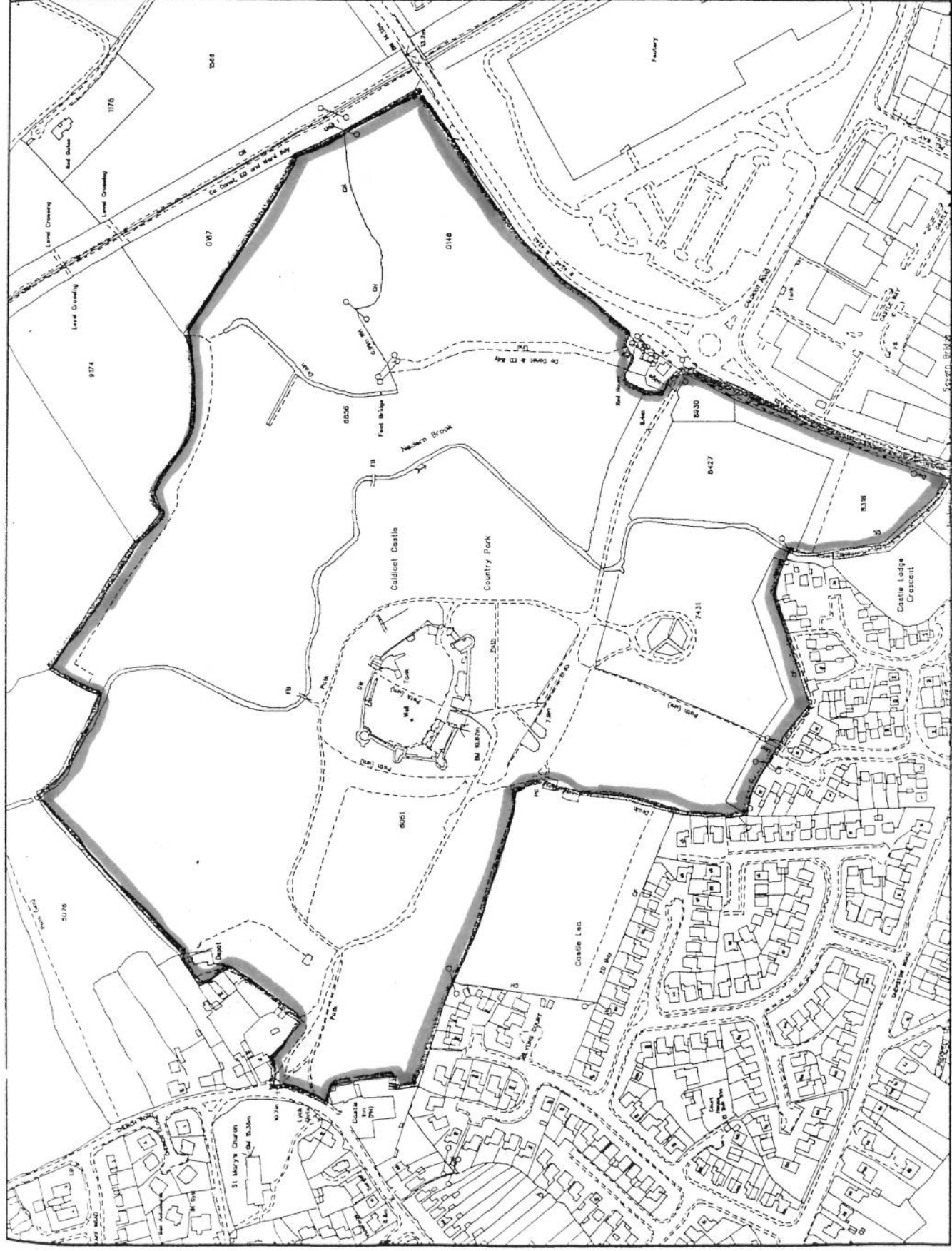

The material in this plot has been reproduced from an Ordnance Survey map with permission of The Controller of Her Majesty's Stationery Office, © Crown copyright. LICENCE NO. LA 09012L

Angidy Ironworks, Intern.

Drawn	repro	24/09/97
-------	-------	----------

Traced		
--------	--	--

Checked		
---------	--	--

Printed		
---------	--	--

Centred on : 351412 200247

Scale 1: 2500

DRG. No.

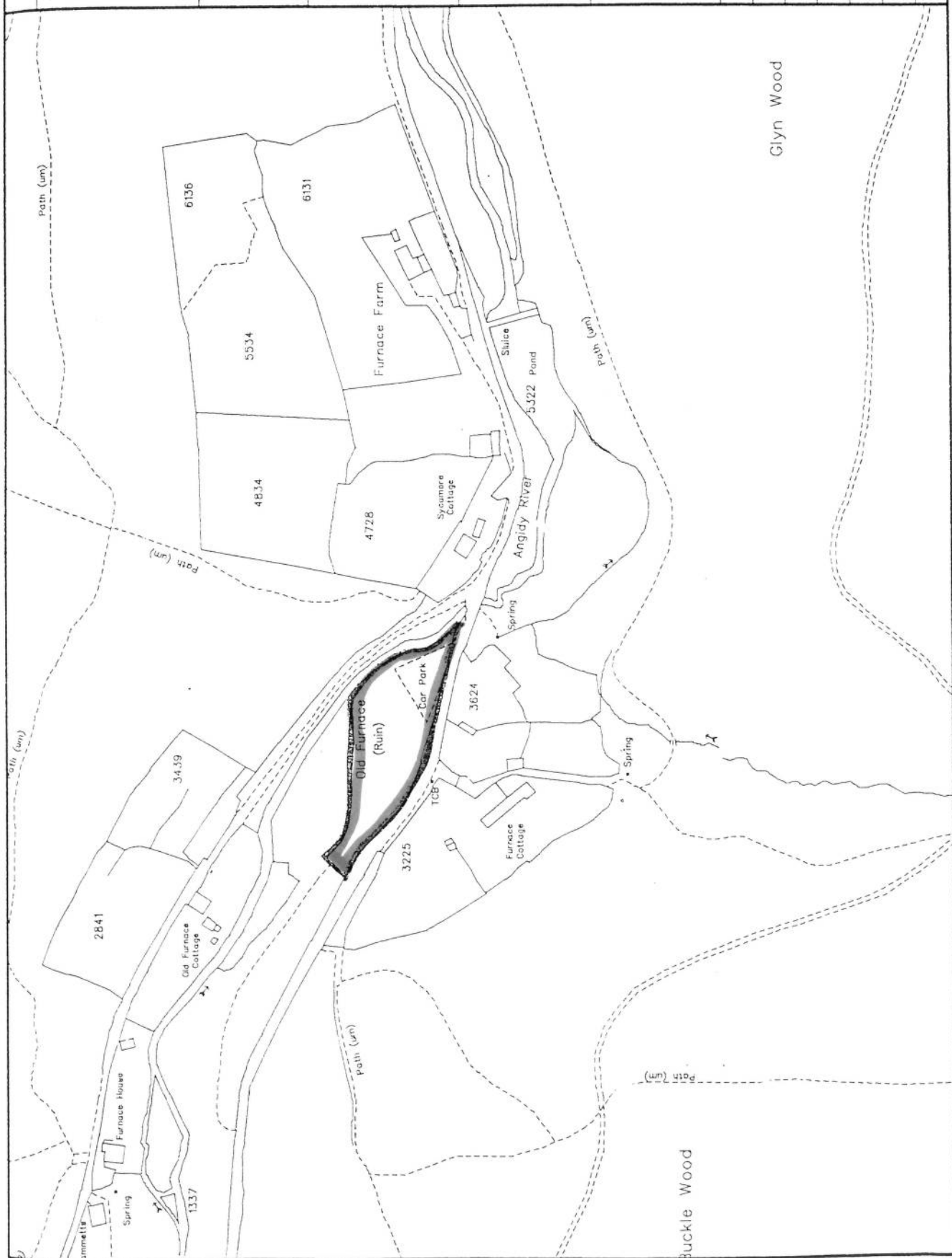

The material in this plot has been reproduced from an Ordnance Survey map with permission of The Controller of Her Majesty's Stationery Office, © Crown copyright. LICENCE NO. LA 09012L

Black Rock Picnic Site, Portskewett.

Drawn	repro	24/09/97
Traced		
Checked		
Print		
Centred on : 351277 188078		
Scale	1:	1250
DRG. No.		

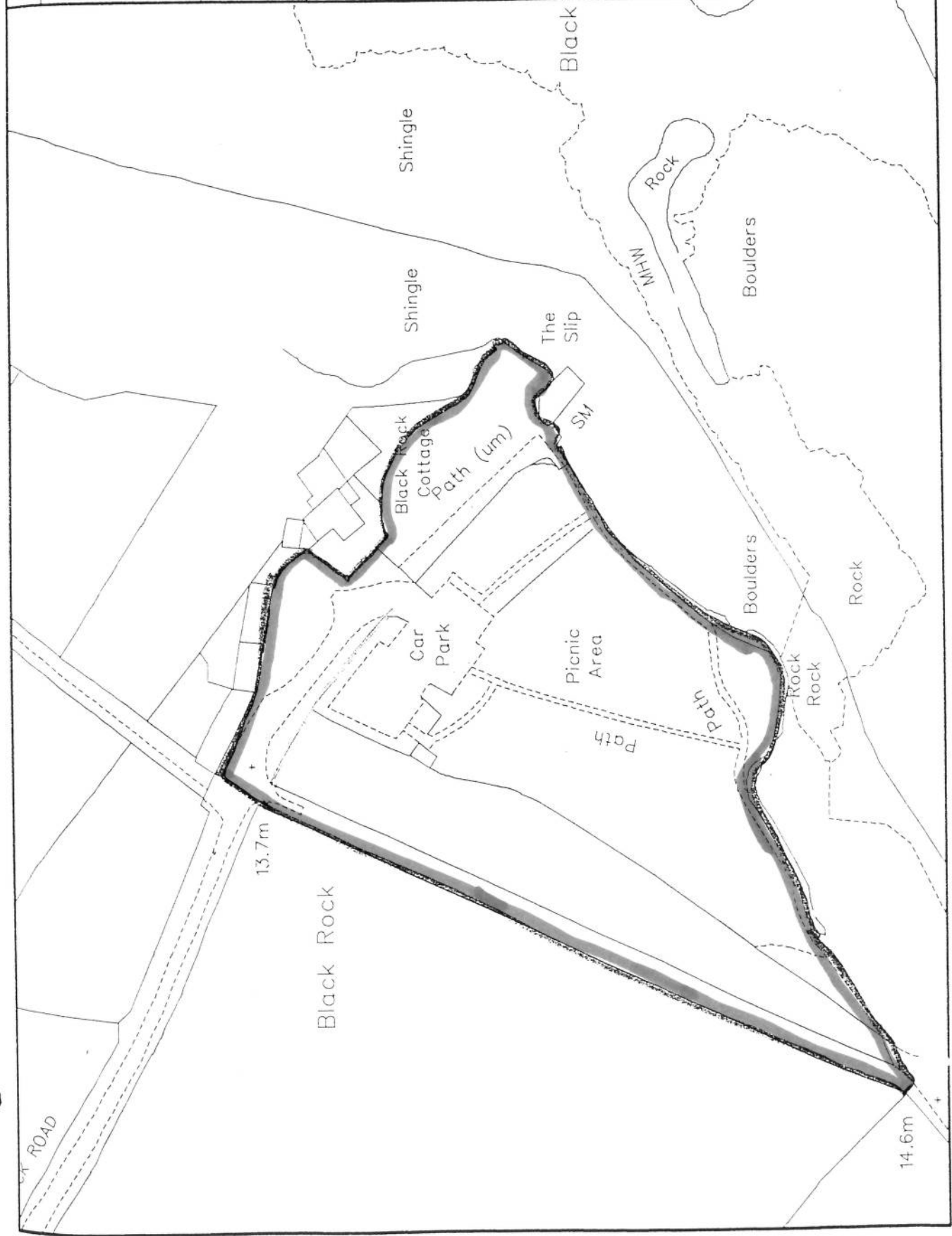

The material in this plot has been reproduced from an Ordnance Survey map with permission of The Controller of Her Majesty's Stationery Office, © Crown copyright. LICENCE NO. LA 09012L

Bluebell Green Picnic Site, Wentwood.

Drawn	repro	26/09/97
Traced		
Checked		
Print		

Centred on : 342250 196149

Scale 1: 5000

DRG. No.



The material in this plot has been reproduced from an Ordnance Survey map with permission of The Controller of Her Majesty's Stationery Office, © Crown copyright. LICENCE NO. LA 09012L

Clydach picnic site,
caravan site and
ironworks.

Drawn repro 24/09/97

Traced

Checked

Print

Centred on : 323128 213392

Scale 1: 4500

DRG. No.

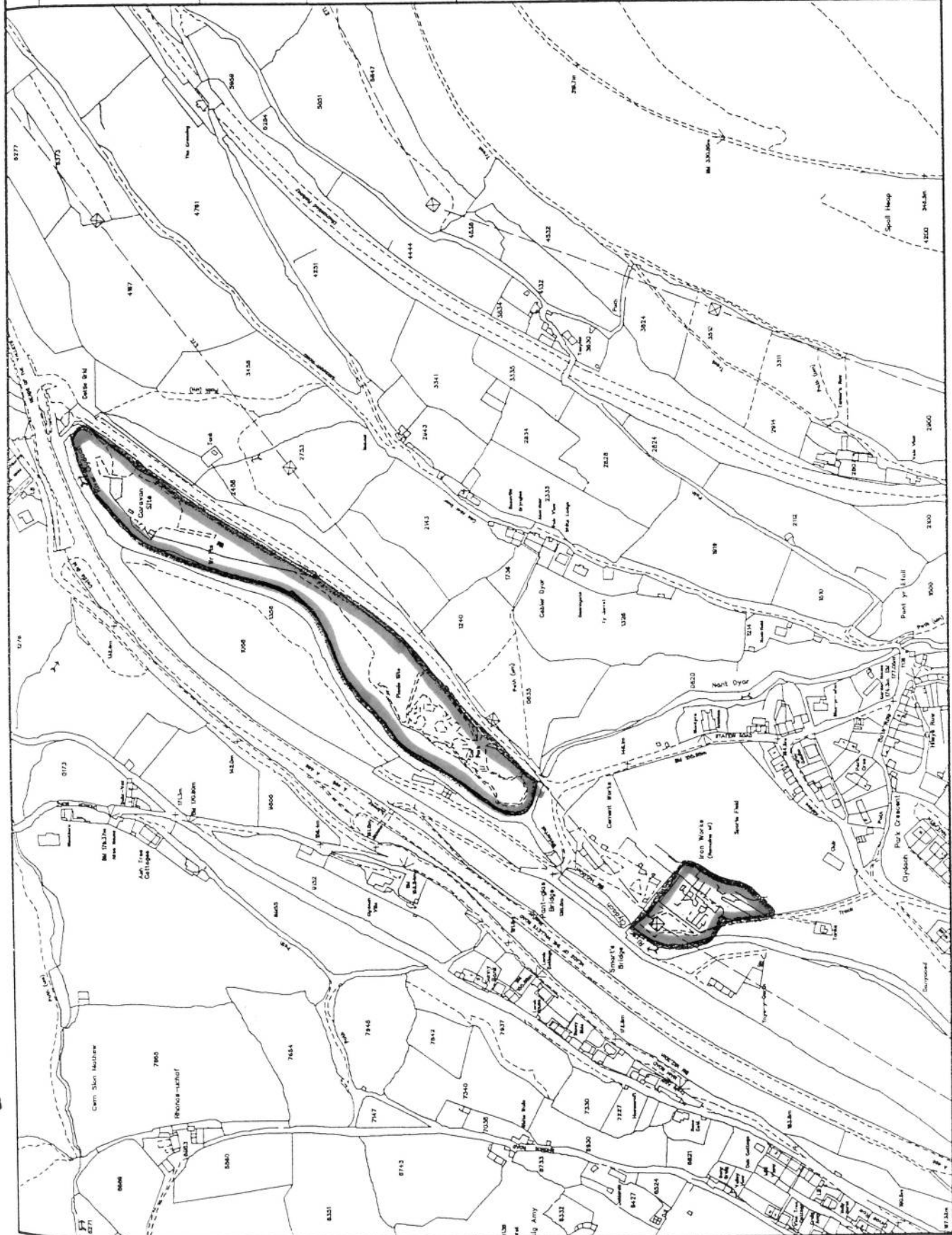

The material in this plot has been reproduced from an Ordnance Survey map with permission of The Controller of Her Majesty's Stationery Office, © Crown copyright. LICENCE NO. LA 09012L

Goitre Wood.

Drawn repro 26/09/97

Traced

Checked

Print

Centred on : 331631 206281

Scale 1: 5000

DRG. No.

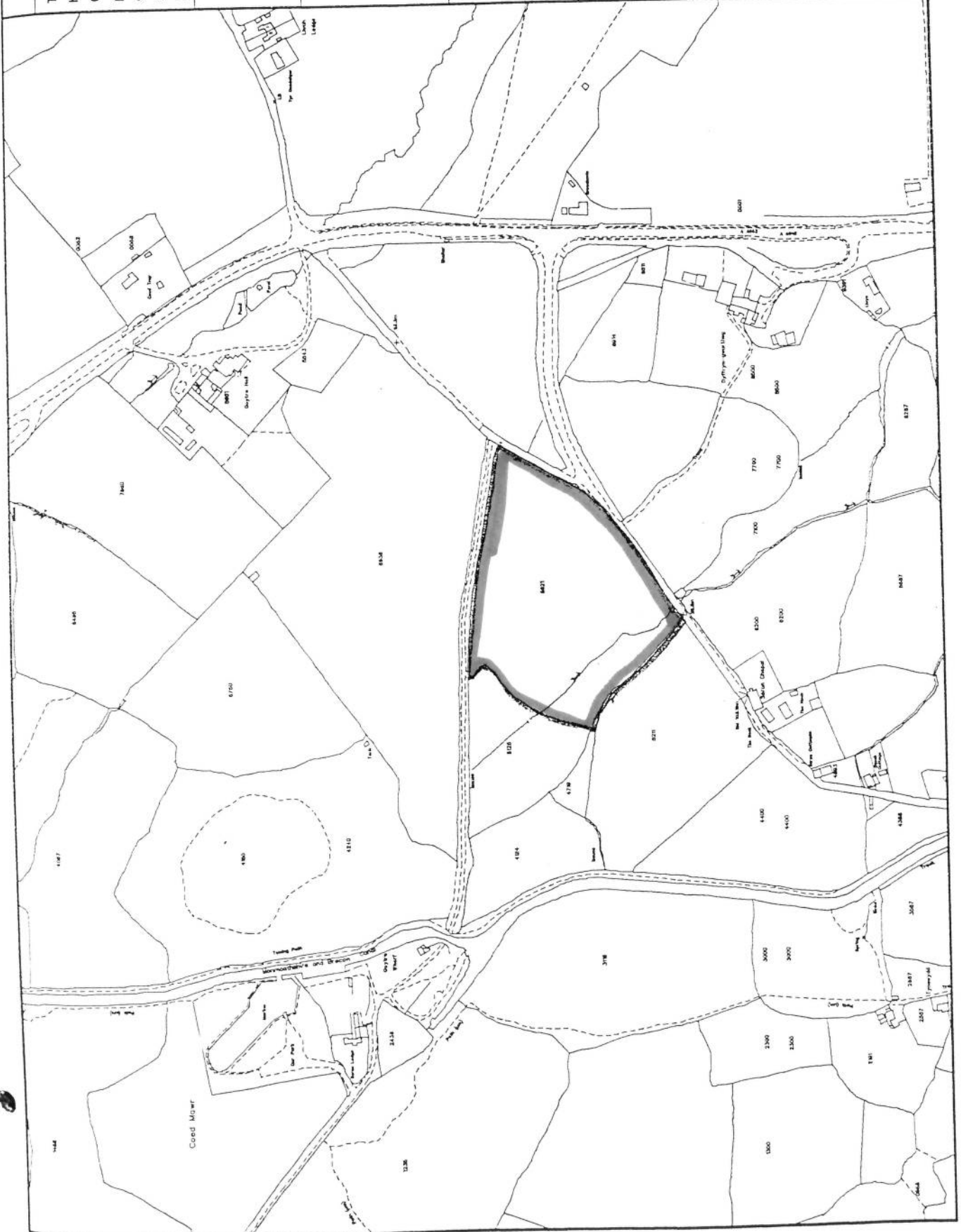

The material in this plot has been reproduced from an Ordnance Survey map with permission of The Controller of Her Majesty's Stationery Office, © Crown copyright. LICENCE NO. LA 09012L

Vauxhall Fields,
Monmouth.

Drawn	repro	24/09/97
Traced		
Checked		
Print		
Centred on : 350287 213162		
Scale 1: 7000		
DRG. No.		

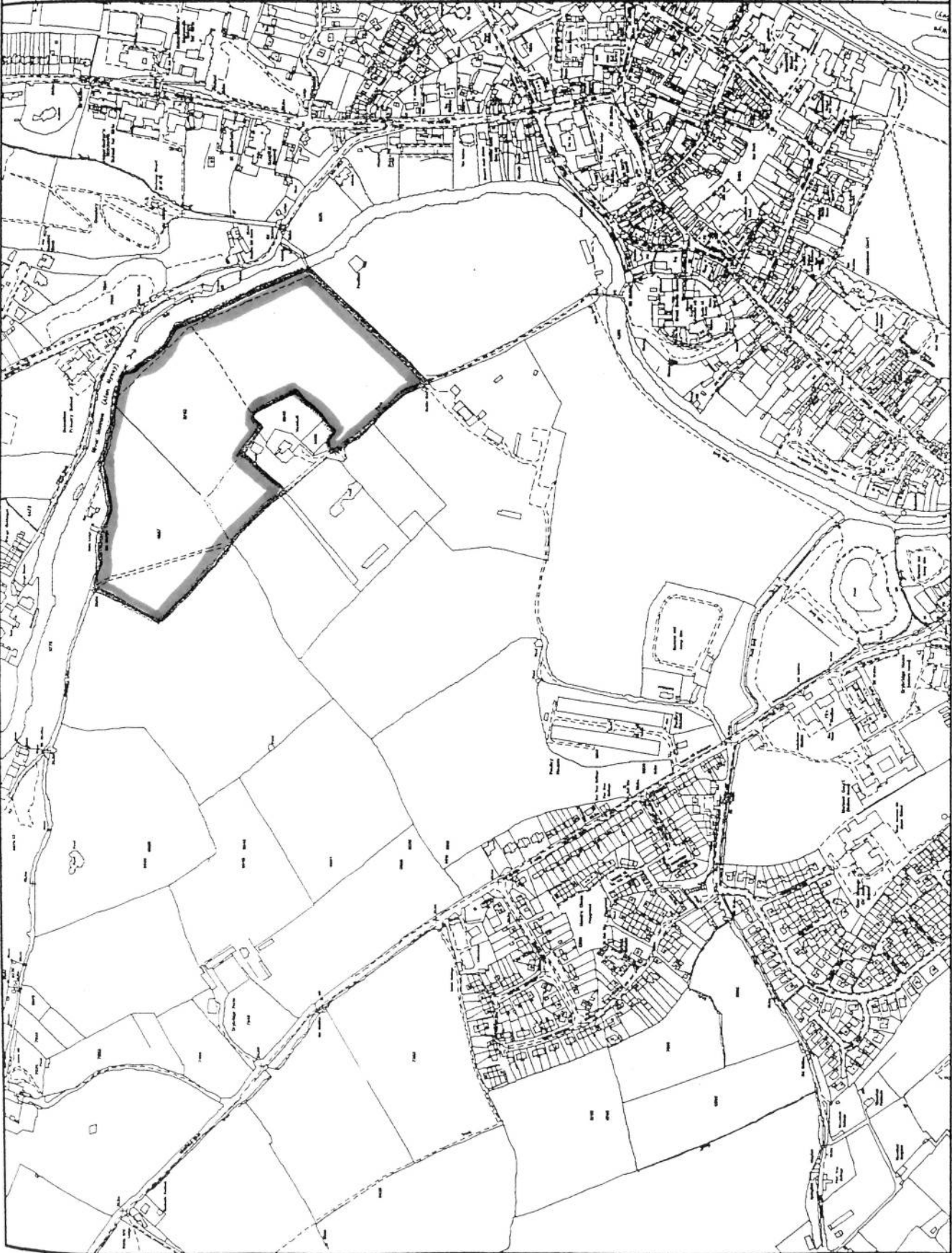

The material in this plot has been reproduced from an Ordnance Survey map with permission of The Controller of Her Majesty's Stationery Office, © Crown copyright. LICENCE NO. LA 09012L

Gilwern Picnic Site.

Drawn	repro	25/09/97
Traced		
Checked		
Print		

Centred on : 324345 214742

Scale 1: 2500

DRG. No.

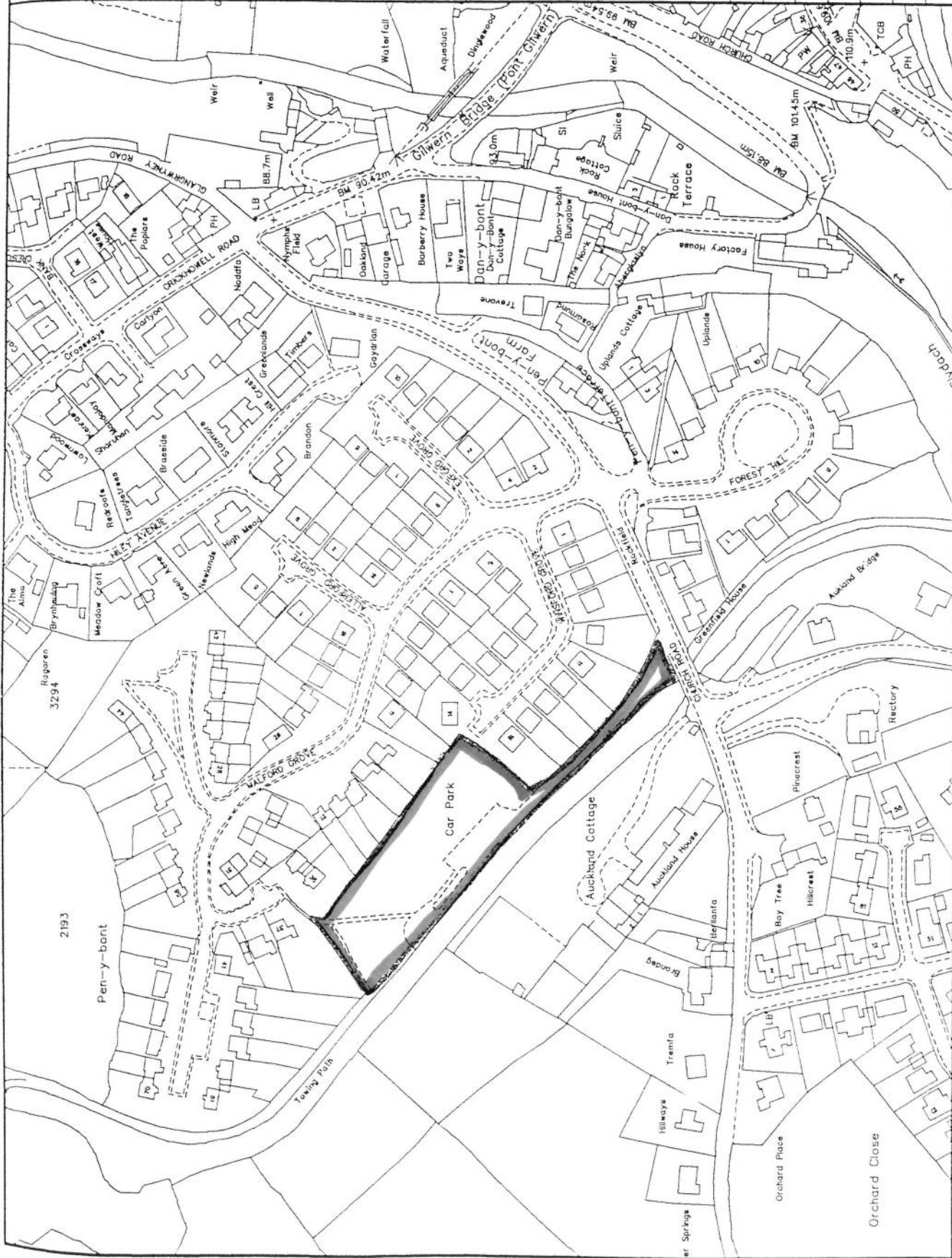

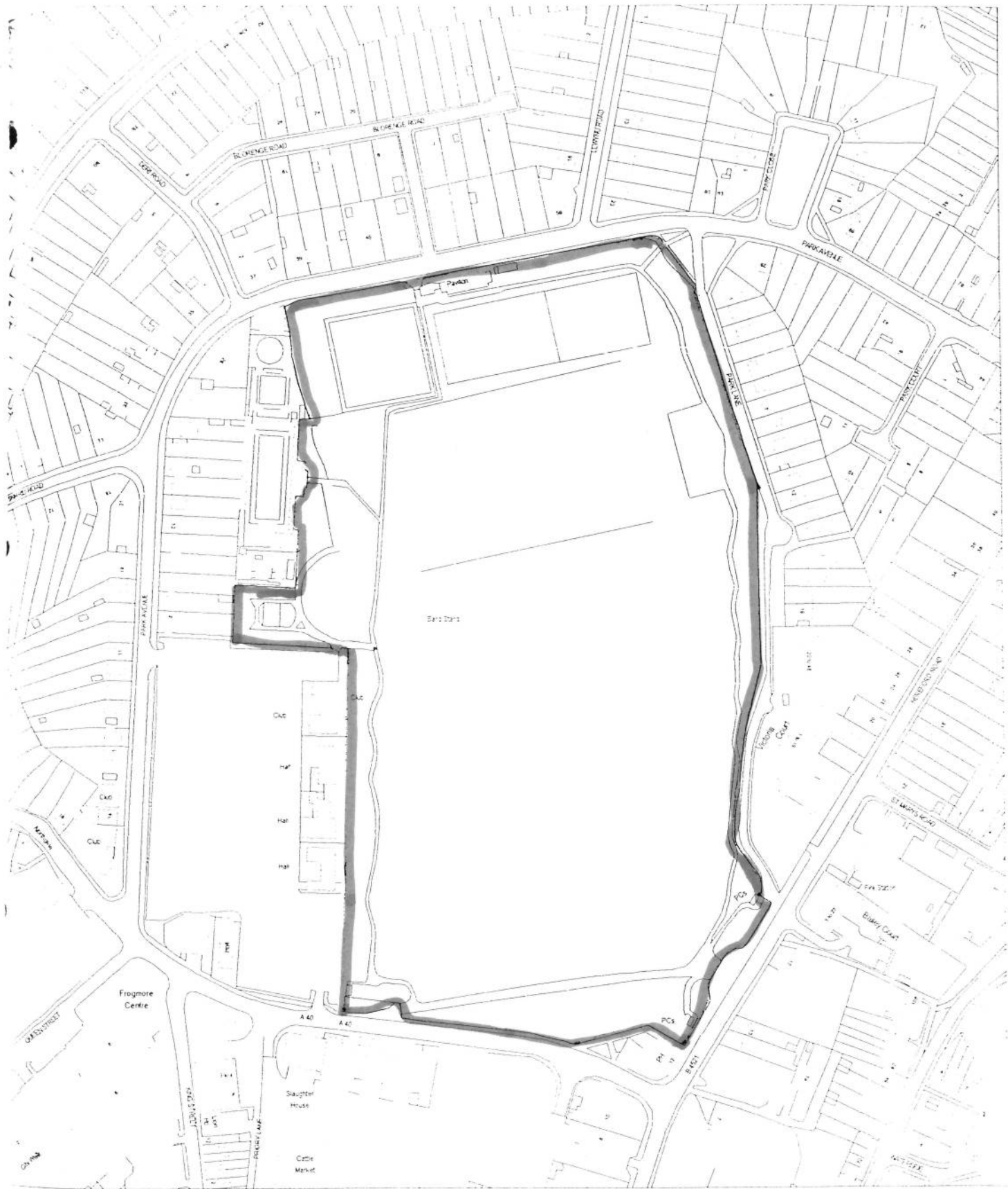

A. J. DAVIES MCI EH FRSH
DIRECTOR OF ENVIRONMENTAL SERVICES

D. J. HARRIS BSc CEng MICE MCIWEM MinstWM
DEPUTY DIRECTOR OF ENVIRONMENTAL SERVICES

Monmouthshire
COUNTY COUNCIL
Abergavenny



JOB TITLE

DOGS(FOULING OF LAND) ACT 1996 - DESIGNATION ORDER
BAILEY PARK ABERGAVENNY

DRAWING No DDO13

SCALE 1:2500

DATE 8/12/1997

MONMOUTHSHIRE COUNTY COUNCIL
© Crown copyright LA 090 12L



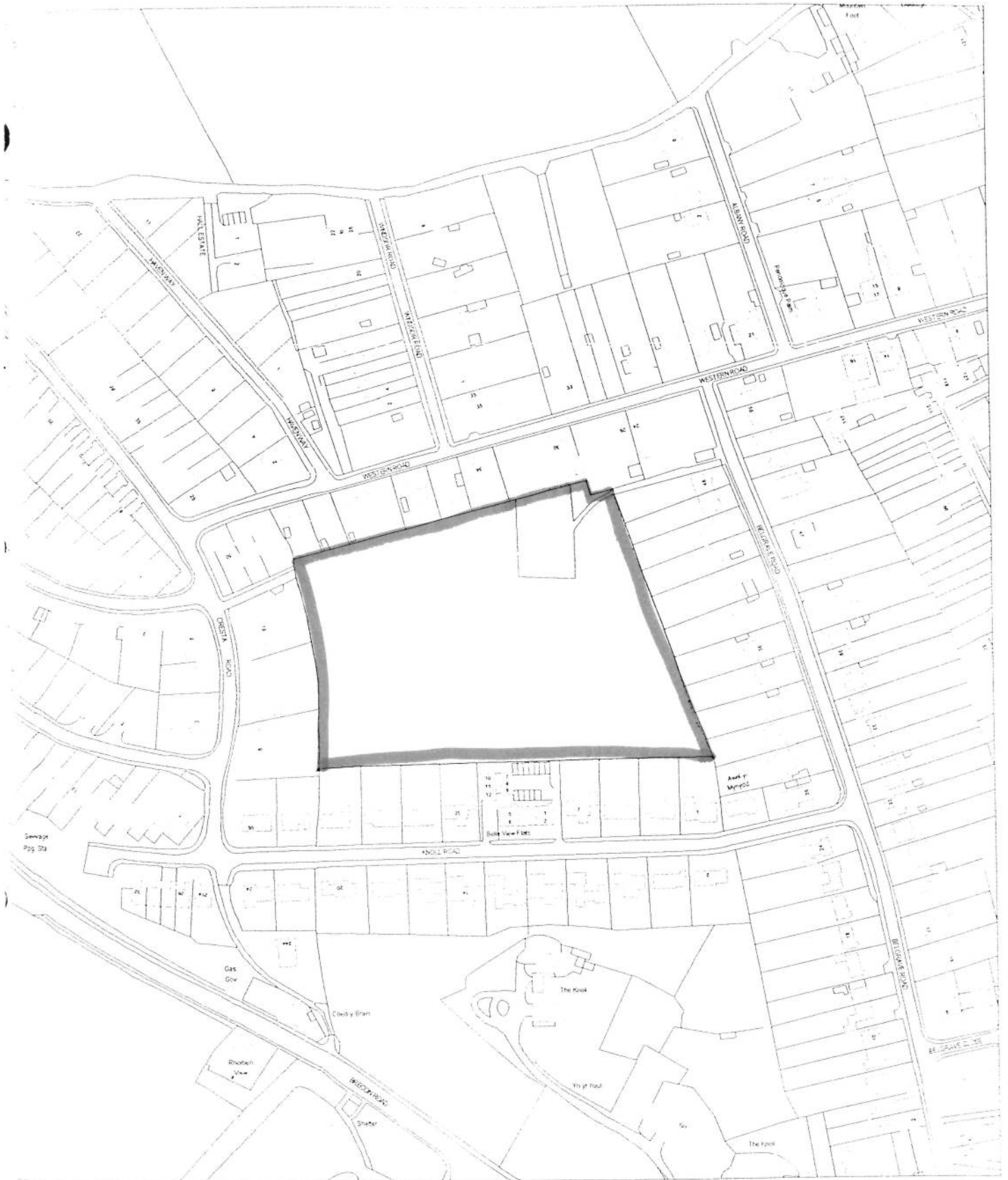

A. J. DAVIES MCIEH FRSH
DIRECTOR OF ENVIRONMENTAL SERVICES

D. J. HARRIS BSc CEng MICE MCIWEM MInstWM
DEPUTY DIRECTOR OF ENVIRONMENTAL SERVICES

monmouthshire
COUNTY COUNCIL



JOB TITLE

DOGS (FOULING OF LAND) ACT 1996 - DESIGNATION ORDER
BELGRAVE PARK ABERGAVENNY

DRAWING No DDO14

SCALE 1:2500

DATE 8112/1997

MONMOUTHSHIRE COUNTY COUNCIL
© Crown copyright LA 090 12L





A.J. DAVIES MCIEH FRSH
 DIRECTOR OF ENVIRONMENTAL SERVICES
 D.J. HARRIS BSc CEng MICE MCIWEM MinstWM
 DEPUTY DIRECTOR OF ENVIRONMENTAL SERVICES

Monmouthshire
 COUNTY COUNCIL



JOB TITLE

DOGS(FOULING OF LAND) ACT 1996 - DESIGNATION ORDER
 LINDA VISTA GARDENS ABERGAVENNY

DRAWING No. DDO15

SCALE 1:2500

DATE 8/12/1997

MONMOUTHSHIRE COUNTY COUNCIL
 © Crown copyright LA 090 12L





Rogiet Primary School



A.J. DAVIES MCIIEH FRSH
DIRECTOR OF ENVIRONMENTAL SERVICES
D.J. HARRIS BSc CEng MICE MCIWEM MinstWM
DEPUTY DIRECTOR OF ENVIRONMENTAL SERVICES



Monmouthshire
COUNTY COUNCIL

JOB TITLE

DOGS(FOULING OF LAND) ACT 1996 - DESIGNATION ORDER
ROGIET PLAYING FIELD

DRAWING No. DDO16

SCALE 1:2500

DATE 8/12/1997

MONMOUTHSHIRE COUNTY COUNCIL
© Crown copyright LA 090 12L





A.J. DAVIES MCIEH FRSH
DIRECTOR OF ENVIRONMENTAL SERVICES
D.J. HARRIS BSc CEng MICE MCIWEM MinStWM
DEPUTY DIRECTOR OF ENVIRONMENTAL SERVICES

Monmouthshire
COUNCIL



JOB TITLE

DOGS(FOULING OF LAND) ACT 1996 - DESIGNATION ORDER
ST MARY PLACE PLAYING FIELD CALDICOT

DRAWING No D0017

SCALE 1:2500

DATE 8/12/1997

MONMOUTHSHIRE COUNTY COUNCIL
© Crown copyright LA 090 12L





A.J. DAVIES MCIEH FRSH
DIRECTOR OF ENVIRONMENTAL SERVICES
D.J. HARRIS BSc CEng MICE MCIWEM MinstWM
DEPUTY DIRECTOR OF ENVIRONMENTAL SERVICES

Monmouthshire
COUNCIL



JOB TITLE

**DOGS(FOULING OF LAND) ACT 1996 - DESIGNATION ORDER
HARDWICK AVENUE PLAYING FIELD CHEPSTOW**

DRAWING No DDO18

SCALE 1:2500

DATE 8/12/1997

MONMOUTHSHIRE COUNTY COUNCIL
© Crown copyright LA 090 12L

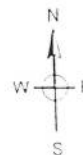



A.J. DAVIES MCIEH FRSH
 DIRECTOR OF ENVIRONMENTAL SERVICES
 D.J.HARRIS BSc CEng MICE MCIWEM MinstWM
 DEPUTY DIRECTOR OF ENVIRONMENTAL SERVICES

JOB TITLE
**DOGS(FOULING OF LAND) ACT 1996 - DESIGNATION ORDER
 THE WARREN, OFF ALPHA ROAD CHEPSTOW**



Monmouthshire
 COUNTY COUNCIL



DRAWING No. DDO19
 DATE 8/12/1997

SCALE 1:2500

MONMOUTHSHIRE COUNTY COUNCIL
 © Crown copyright LA 090 12L

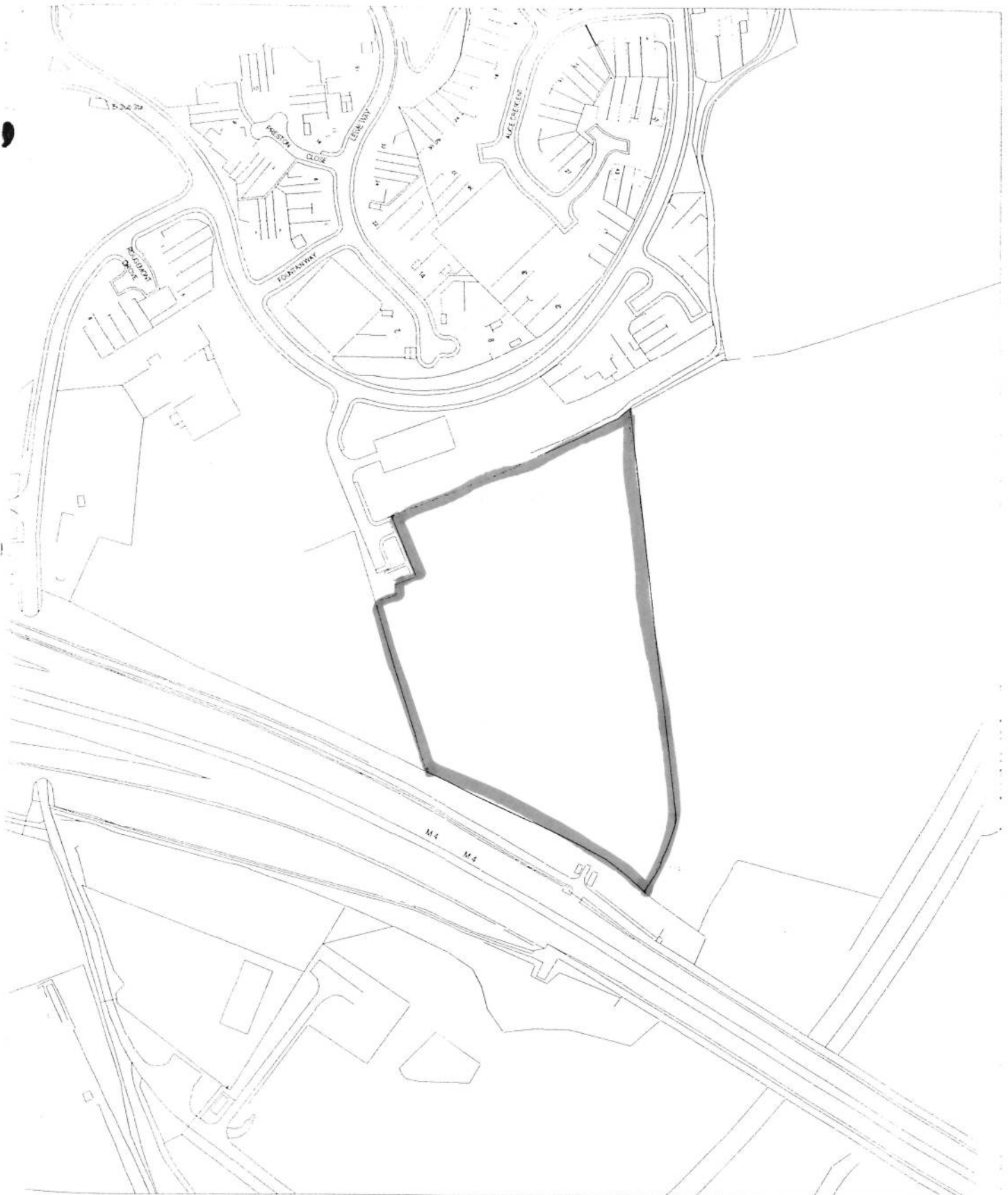

A.J. DAVIES MCI EH FRSH
DIRECTOR OF ENVIRONMENTAL SERVICES

D.J. HARRIS BSc CEng MICE MCIWEM MinstWM
DEPUTY DIRECTOR OF ENVIRONMENTAL SERVICES

Monmouthshire
COUNTY COUNCIL



JOB TITLE

DOGS(FOULING OF LAND) ACT 1996 - DESIGNATION ORDER
THORNWELL PLAYING FIELDS CHEPSTOW

DRAWING No. DDO21

SCALE 1:2500

DATE 9/12/1997

MONMOUTHSHIRE COUNTY COUNCIL
© Crown copyright LA 090 12L



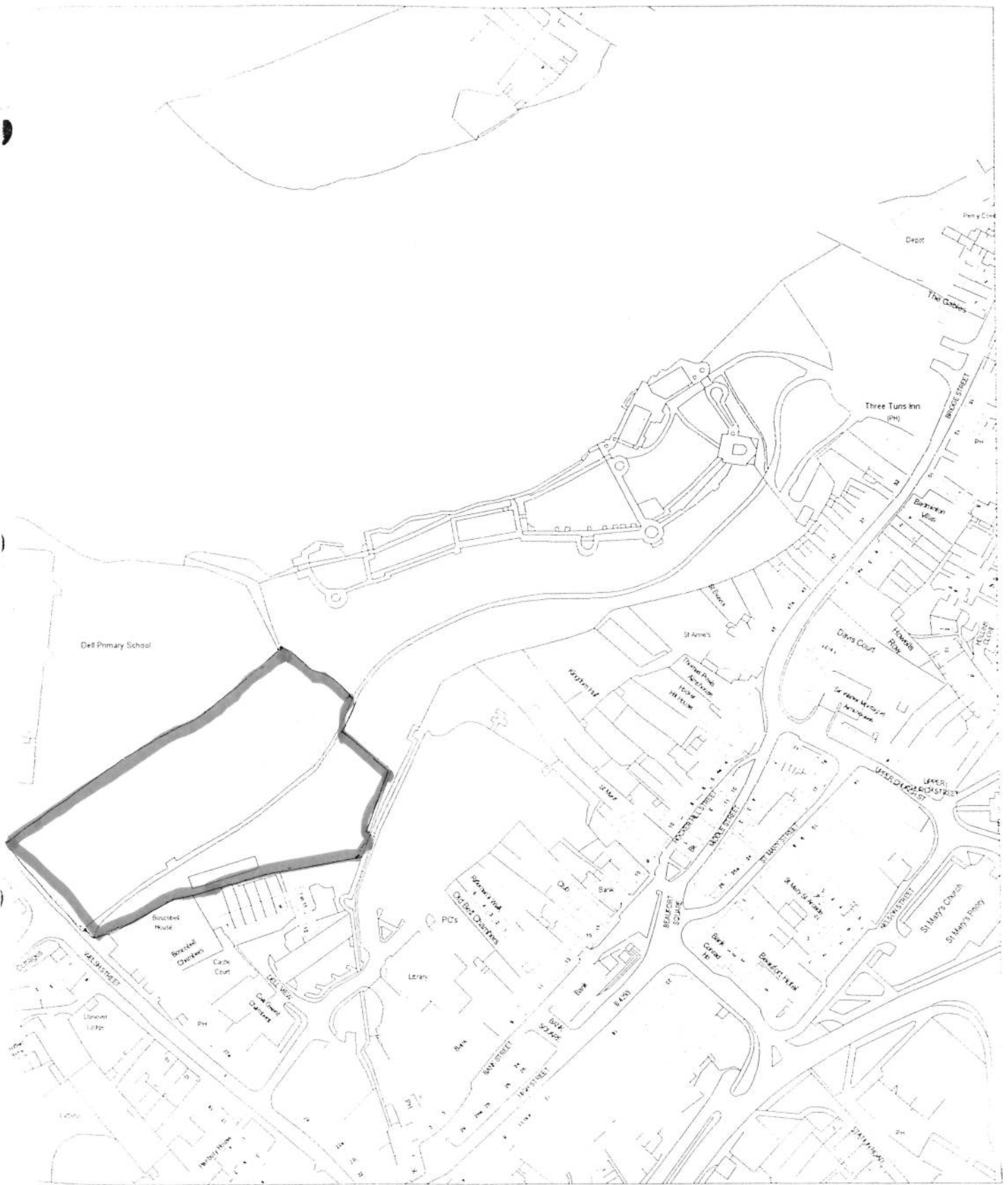

A.J. DAVIES MCIEH FRSH
 DIRECTOR OF ENVIRONMENTAL SERVICES
 D.J. HARRIS BSc CEng MICE MCIWEM MinstWM
 DEPUTY DIRECTOR OF ENVIRONMENTAL SERVICES

monmouthshire
 COUNTY COUNCIL



JOB TITLE

**DOGS (FOULING OF LAND) ACT 1996 - DESIGNATION ORDER
 CASTLE DELL CHEPSTOW**

DRAWING No DDO22

SCALE 1:2500

DATE 8/12/1997

MONMOUTHSHIRE COUNTY COUNCIL
 © Crown copyright LA 090 12L





A.J. DAVIES MCIEH FRSH
 DIRECTOR OF ENVIRONMENTAL SERVICES
 D.J. HARRIS BSc CEng MICE MCIWEM MInstWM
 DEPUTY DIRECTOR OF ENVIRONMENTAL SERVICES

JOB TITLE

**DOGS(FOULING OF LAND) ACT 1996 - DESIGNATION ORDER
 CHEPSTOW RIVER BANK**

DRAWING No DDO23

SCALE 1:2500

DATE 8/12/1997

MONMOUTHSHIRE COUNTY COUNCIL
 C. Crown copyright LA 090 12L



mouthshire
 COUNTY COUNCIL



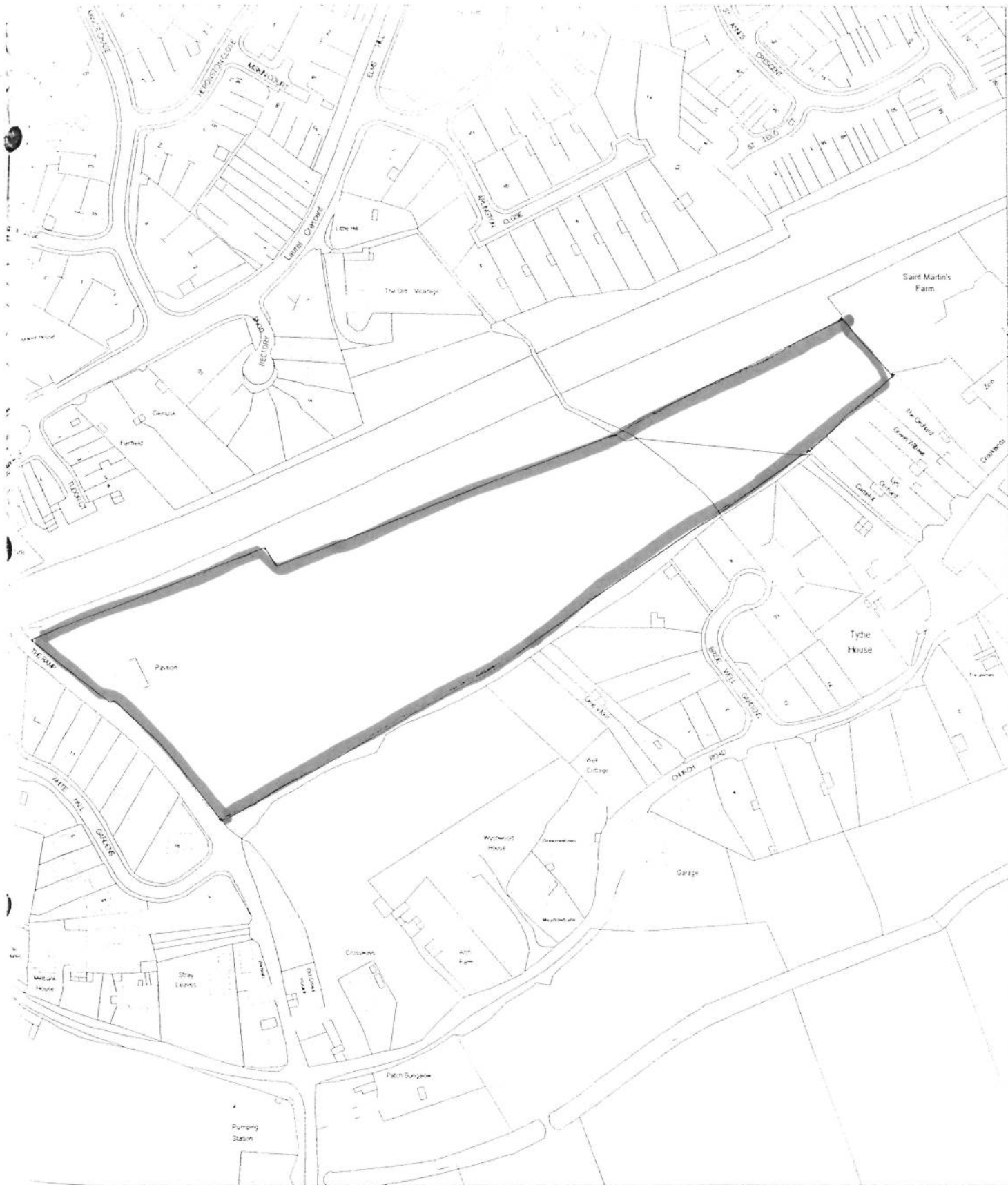

A.J. DAVIES MCIEH FRSH
DIRECTOR OF ENVIRONMENTAL SERVICES

D.J. HARRIS BSc CEng MICE MCIWEM MinstWM
DEPUTY DIRECTOR OF ENVIRONMENTAL SERVICES

Monmouthshire
COUNTY COUNCIL



JOB TITLE

DOGS(FOULING OF LAND) ACT 1996 - DESIGNATION ORDER
UNDY PLAYING FIELDS

DRAWING No. DDO25

SCALE 1:2500

DATE 8/12/1997

MONMOUTHSHIRE COUNTY COUNCIL
© Crown copyright LA 090 12L





A.J. DAVIES MCIEH FRSH
 DIRECTOR OF ENVIRONMENTAL SERVICES
 D.J. HARRIS BSc CEng MICE MCIWEM MInstWM
 DEPUTY DIRECTOR OF ENVIRONMENTAL SERVICES

JOB TITLE
**DOGS(FOULING OF LAND) ACT 1996 - DESIGNATION ORDER
 LLANDEWI RHYDDERCH PLAY AREA**



DRAWING No DDO26 SCALE 1:2500
 DATE 8/12/1997
 MONMOUTHSHIRE COUNTY COUNCIL
 © Crown copyright LA 090 12L

Monmouthshire
 COUNTY COUNCIL





A.J. DAVIES MCIEH FRSH
 DIRECTOR OF ENVIRONMENTAL SERVICES
 D.J. HARRIS BSc CEng MICE MCIWEM MinstWM
 DEPUTY DIRECTOR OF ENVIRONMENTAL SERVICES

Monmouthshire
 COUNTY COUNCIL



JOB TITLE
**DOGS(FOULING OF LAND) ACT 1996 - DESIGNATION ORDER
 LLANVAPLEY CRICKET AND PLAY AREA**

DRAWING No.	DD027	SCALE	1:2500
DATE	8/12/1997	MONMOUTHSHIRE COUNTY COUNCIL © Crown copyright LA 090 12L	





A.J. DAVIES MCIEH FRSH
DIRECTOR OF ENVIRONMENTAL SERVICES

D.J. HARRIS BSc CEng MICE MCIWEM MinstWM
DEPUTY DIRECTOR OF ENVIRONMENTAL SERVICES



JOB TITLE

**DOGS(FOULING OF LAND) ACT 1996 - DESIGNATION ORDER
LLANVAIR KILGEDDIN PLAY AREA**

DRAWING No DDO28

SCALE 1:2500

DATE 8/12/1997

MONMOUTHSHIRE COUNTY COUNCIL
© Crown copyright LA 090 12L



monmouthshire
COUNTY COUNCIL

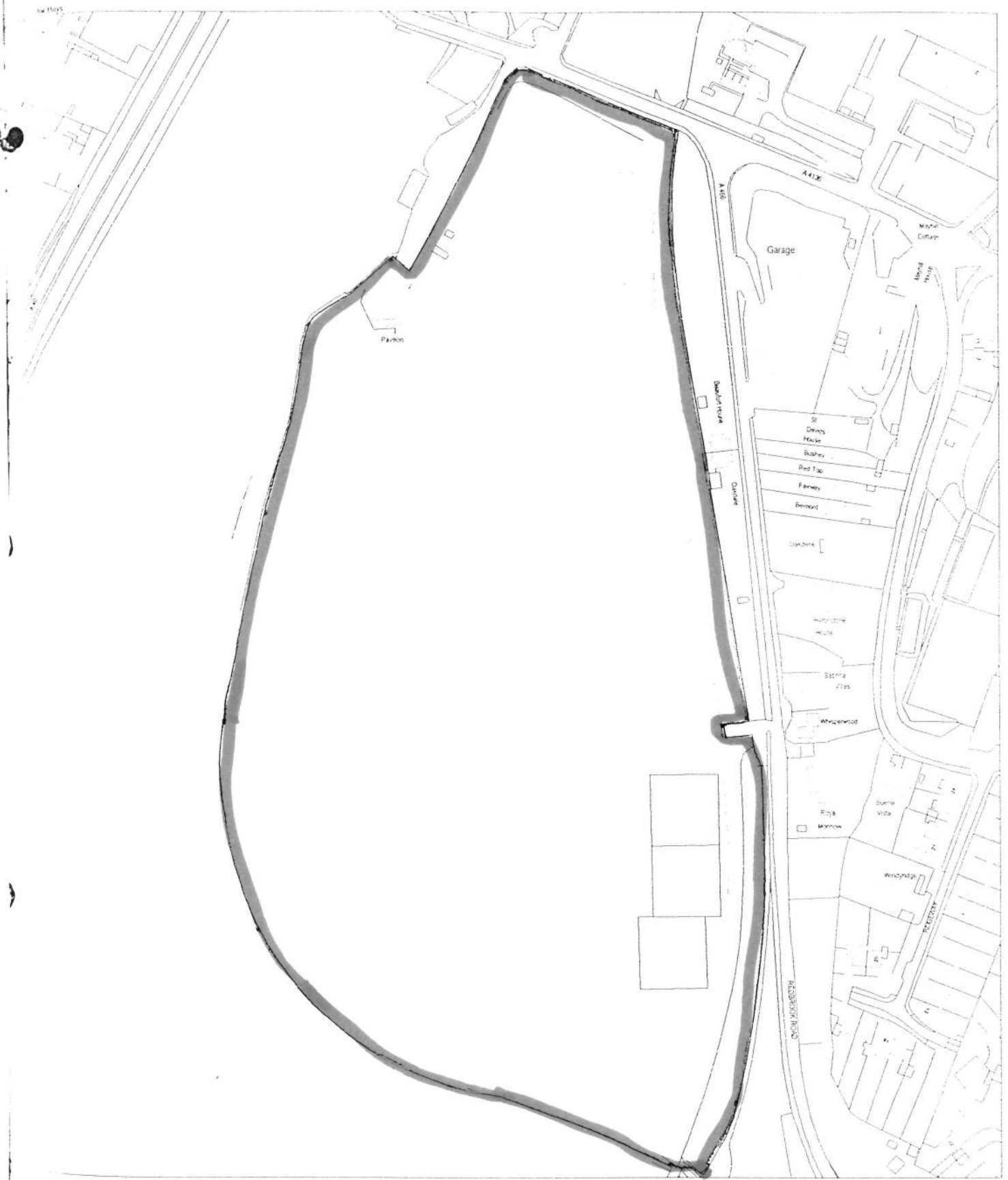

A.J. DAVIES MCIEH FRSH
 DIRECTOR OF ENVIRONMENTAL SERVICES
 D.J. HARRIS BSc CEng MICE MCIWEM MinstWM
 DEPUTY DIRECTOR OF ENVIRONMENTAL SERVICES

JOB TITLE
**DOGS(FOULING OF LAND) ACT 1996 - DESIGNATION ORDER
 MONMOUTH SCHOOL PLAYING FIELDS**



DRAWING No. DDO30 SCALE 1:2500
 DATE 8/12/1997
 MONMOUTHSHIRE COUNTY COUNCIL
 © Crown copyright LA 090 12L



Monmouthshire
 COUNTY COUNCIL



A.J. DAVIES MCIH FRSH
 DIRECTOR OF ENVIRONMENTAL SERVICES
 D.J.HARRIS BSc CEng MICE MCIWEM MinstWM
 DEPUTY DIRECTOR OF ENVIRONMENTAL SERVICES

JOB TITLE
**DOGS(FOULING OF LAND) ACT 1996 - DESIGNATION ORDER
 USK CRICKET GROUND**



Monmouthshire
 COUNTY COUNCIL



DRAWING No.	DDO31	SCALE	1:2500
DATE	8/12/1997	MONMOUTHSHIRE COUNTY COUNCIL Crown copyright LA 090 12L	

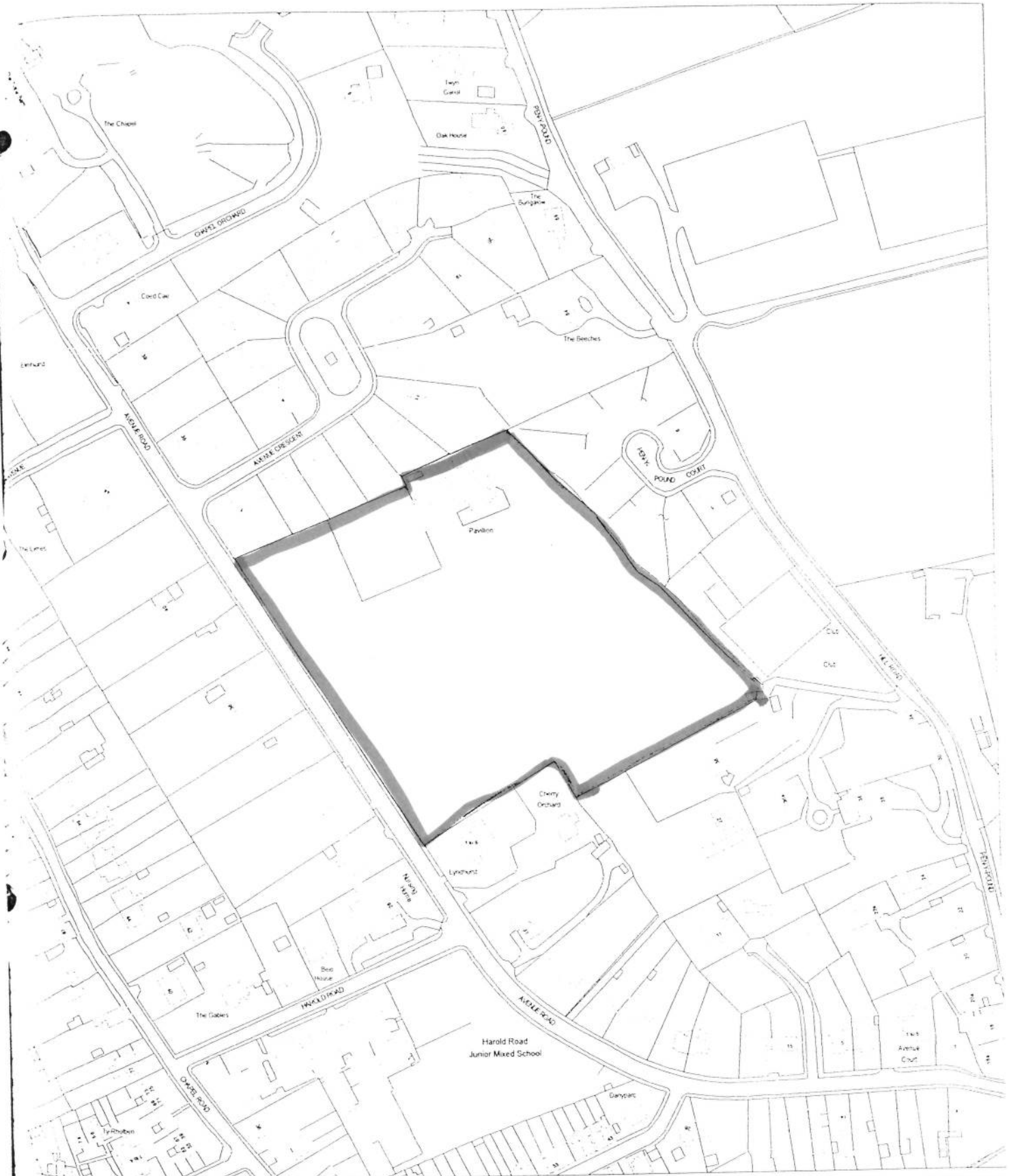

A.J. DAVIES MCIEH FRSH
 DIRECTOR OF ENVIRONMENTAL SERVICES
 D.J.HARRIS BSc CEng MICE MCIWEM MInstWMM
 DEPUTY DIRECTOR OF ENVIRONMENTAL SERVICES

JOB TITLE
**DOGS(FOULING OF LAND) ACT 1996 - DESIGNATION ORDER
 ABERGAVENNY CRICKET GROUND**



DRAWING No. DDO32 SCALE 1:2500
 DATE 8/12/1997 MONMOUTHSHIRE COUNTY COUNCIL
 © Crown copyright LA 090 12L

Monmouthshire
 COUNTY COUNCIL

